

| EQUIPMENT SCHEDULE | | | | | | |
|--------------------|-------------|-----|--------------------|------------------------------------|---------------|---------|
| ITEM NO | PROVIDED BY | QTY | MANUFACTURER | EQUIPMENT CATEGORY | MODEL NUMBER | ITEM NO |
| 1 | EXISTING | 1 | ADVANCE TABCO | SINK, MOP | 9-OP-40 | 1 |
| 2 | EXISTING | 1 | T & S BRASS | SERVICE SINK FAUCET, WALL MOUNT | B-0655-BSTP | 2 |
| 3 | KEC | 1 | ADVANCE TABCO | SINK,HAD | 7-PS-23 | 3 |
| 4 | 4 | 1 | INFRICO USA | FREEZER, REACH-IN, TOP MOUNTED | IRR-AGB23BT | 4 |
| 5 | KEC | 1 | SOUTHBEND | HOT PLATE, GAS | HDO-12 | 5 |
| 6 | KEC | 1 | VANENCIO | BROILER,UNDERFIRE,COUNTERTOP | HDO-24 | 6 |
| 7 | KEC | 1 | AERO MANUFACTURING | STAND, EQUIPMENT | 4EG-3036 | 7 |
| 8 | KEC | 1 | ACCU-TEMO | GRIDDLE,GAS | PGF1201B3650 | 8 |
| 9 | KEC | 1 | INFRICO USA | EQUIPMENT STAND, REFRIGERATED BASE | IUC-MSG48 | 9 |
| 10 | KEC | 1 | SOUTHBEND | FRYER,DEEP FAT, GAS | 50LB | 10 |
| 11 | EXISTING | 1 | TBD | TYPE I GREASE HOOD | 10 FOOT HOOD | 11 |
| 12 | KEC | 1 | SOUTHBEN | OVEN, CONVECTION | GH/20CCH | 12 |
| 13 | KEC | 1 | INFRICO USA | FREEZER, UNDERCOUNTER | IUC-MR41BT | 13 |
| 14 | KEC | 1 | INFRICO USA | REFRIGERATOR, SANDWICH/SALAD PREP | IRT-UC60PMT | 14 |
| 15 | KEC | 1 | INFRICO USA | REFRIGERATOR, SANDWICH/SALAD PREP | IRT-UC48PMT | 15 |
| 16 | KEC | 1 | HATCO | TOASTER | IQC-1000 | 16 |
| 17 | KEC | 1 | ADVANCE TABCO | TABLE, WORK | EG-308 | 17 |
| 18 | KEC | 1 | T & S BRASS | PRE-RINSE FAUCET, WALL MOUNT | B-0133 | 18 |
| 19 | KEC | 1 | ADVANCE TABCO | DISHTABLE,L SHAPE | DTS-D30-48 | 19 |
| 21 | KEC | 1 | ADVANCE TABCO | DISHTABLE, STRAIGHT | DTS-S60-48 | 21 |
| 22 | KEC | 1 | ADVANCE TABCO | SINK,3 COMP | FS3-1620-18-R | 22 |
| 23 | KEC | 1 | ADVANCE TABCO | SHELF, WALL | WS-15-72 | 23 |
| 24 | KEC | 1 | ADVANCE TABCO | TABLE, WORK | KSS-307 | 24 |
| 25 | EXISTING | 1 | ATOSA | BIN, ICE | B40PS | 25 |
| 26 | EXISTING | 1 | ATOSA | ICE MAKER W/O BIN | CIM0320A | 26 |
| 27 | VENDOR | 1 | LANCER | BEVERAGE | BAGINBOX | 27 |
| 28 | VENDOR | 1 | FEBERAL | GRAB-AND-GO | AS TO PLAN | 28 |
| 29 | KEC | 1 | PERLICK | BARK BAR REFRIGERATION | BBS84 | 29 |
| 30 | KEC | 1 | PERLICK | BACK BAR REFRIGERATION | BBS84 | 30 |
| 31 | KEC | 1 | PERLICK | PASS THRU REFRIGERATION | PTS80 | 31 |
| 32 | KEC | 1 | PERLICK | UNDERBAR 4 COMPARTMENT SINK | TSD74C | 32 |
| 33 | KEC | 1 | PERLICK | UNDERBAR DRAINBOARD | TS12 | 33 |
| 34 | KEC | 1 | PERLICK | SPEED RAIL | SRC-S36 | 34 |
| 35 | KEC | 1 | PERLICK | COOLER, BOTTLE, LOW TEMP | BC36LT | 35 |
| 36 | KEC | 1 | PERLICK | UNDERBAR COCKTAIL STATION | PTE68-C-WF | 36 |
| 37 | KEC | 1 | PERLICK | UNDERBAR DRAINBOARD | TS18 | 37 |
| 38 | EXISTING | 1 | ATOSA | DISPENSER, BEER | KC90SNSS | 38 |

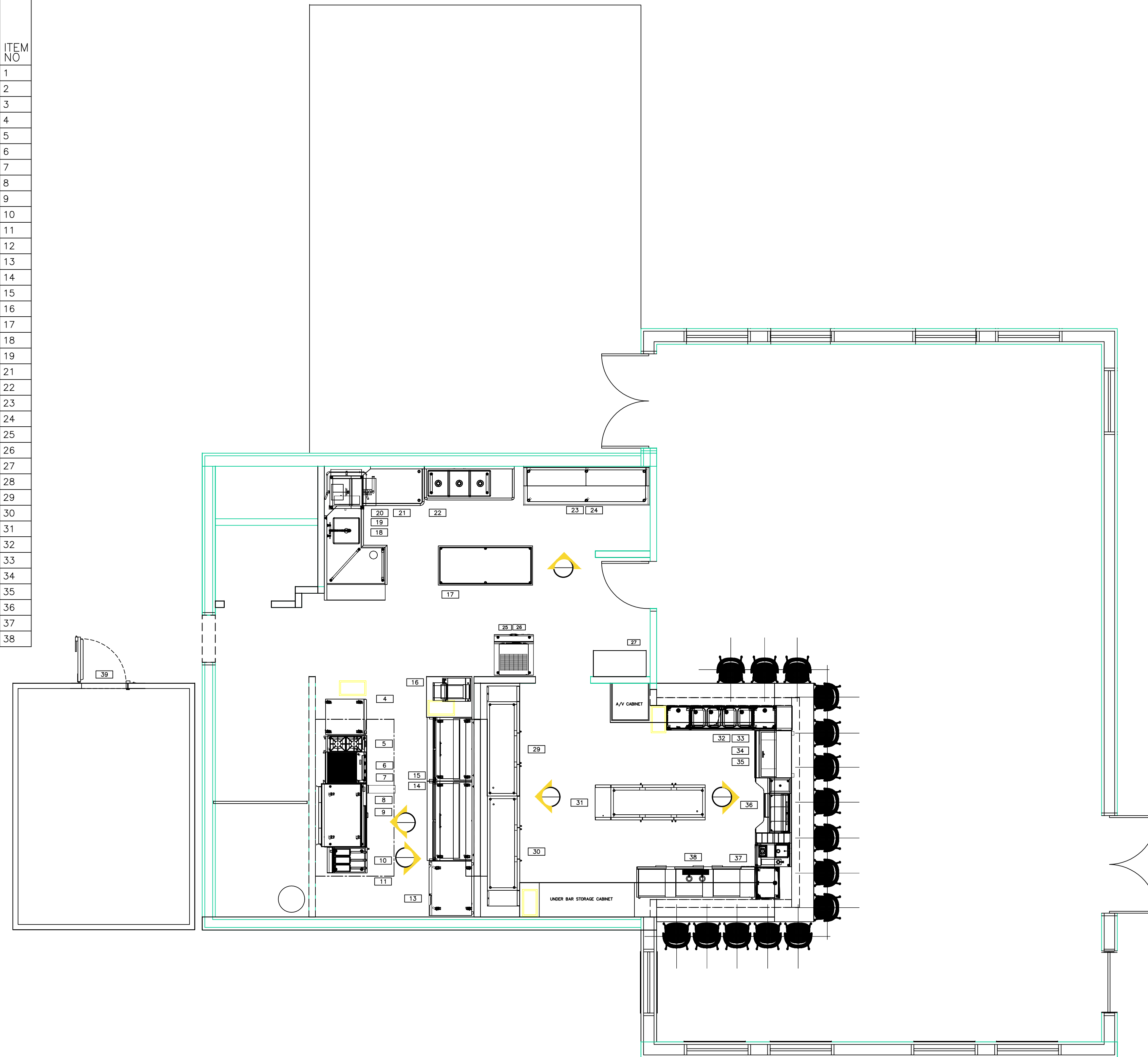

PROJECT:
 FOOD SERVICE EQUIPMENT PLAN FOR:
 BUFFALO CREEK COLF COURSE
 8100 69TH STREET EAST
 PARRISH, FLORIDA 34221
 © COPYRIGHT 2024 0770 SRAG LLC, FOODSERVICE DESIGN CONSULTANTS

| No. | REVISION | DATE |
|-----|----------|------|
| | | |
| | | |
| | | |
| | | |
| | | |
| | | |
| | | |

| | |
|-------------|------------|
| PROJECT No. | BUFF |
| ISSUE DATE | 9.10.2024 |
| DRAWN BY | BKM |
| CHECKED BY | BKM |
| DWG No. | 9.10.2024 |
| SCALE | 1/4"=1'0" |
| PLOT DATE | 09.12.2024 |

| | |
|-----------------------------|--|
| SHEET TITLE | |
| FOOD SERVICE EQUIPMENT PLAN | |
| SHEET | |
| FS 1.1 | |
| OF - SHEETS | |

FOOD SERVICE EQUIPMENT PLAN

SCALE 1/4"=1'0"
 NUMBER OF SEATS - TBD
 TOTAL FACILITY AREA - 2004 SQFT